





The Craft Beer Bunker

An incredibly unique craft beer bar set in the coolest mix of containers.

SPECIFICATION

This double shipping container has been transformed in to a double open-sided wood-filled bar like no other. With a seated viewing gallery and downstairs deck next to the bar, The Craft Beer Bunker can seat up to 100+ guests in a rustic setting.

Minimum floor space required: 12m x 12m

Arrives on 1 x vehicle

Seats: 60+

Set up: Between 3hrs & 6hrs depending on size and specification options



OUR CHARGES

Depending on the type of event, we offer many scalable pricing options that include;



Customising our bars, staff and equipment to your brand, activation or theme.

A full drinks package for private hire where you choose to sell to your guests, provide complimentary or a combination of both.

A dry bar where you provide staff and stock (drink brands only).

We also offer you a percentage return on sales (subject to negotiation).



FROM
£5,995.00*

Please note that charges are based on a one-day hire charge

Additional days are charged at £1,500 per day

*Charges are subject to location, ease of access and total number of expected guests

+44 (0)8454 750 796 sarah@arenasportslive.com aslactive.com
ASL ACTIVATION & EVENTS, OXFORD, OX12 9FF UK



WHAT'S INCLUDED

Shipping containers that transform into the bar

Transport and crane hire to and from the event

Stairs to large roof gallery with seating, parasols and heaters

Downstairs bar & decking area

Premium Rattan & bespoke seating for up to 100 people

Internal stock, washing and preparation room

Bar and stock room fridges

Production crew to set up and dismantle

Bar & equipment Manager throughout event

Internal sound system

EPOS payment system



ADDITIONS THAT WE CAN ARRANGE

Drinks packages bespoke to your event

Beautiful bar & table service staff

Theatrical flair bartenders

DJ & Sound System

Fire Pits & Outdoor Heaters

Extra outdoor seating

Stretch fabric marquee roof 10m x 10m

Large 16m diameter star shade

Bespoke branded glassware

Bespoke branded bar, POS & parasols

Fridge/Freezer Stock Vehicle

Bespoke bartenders uniforms

Additional 10 seater

VIP Outdoor Rooms



A personalised menu and bespoke drinks to you or your brand or event

WE ASK YOU TO PROVIDE

A level surface area

Power

Suitable access (venue viewing is recommended)





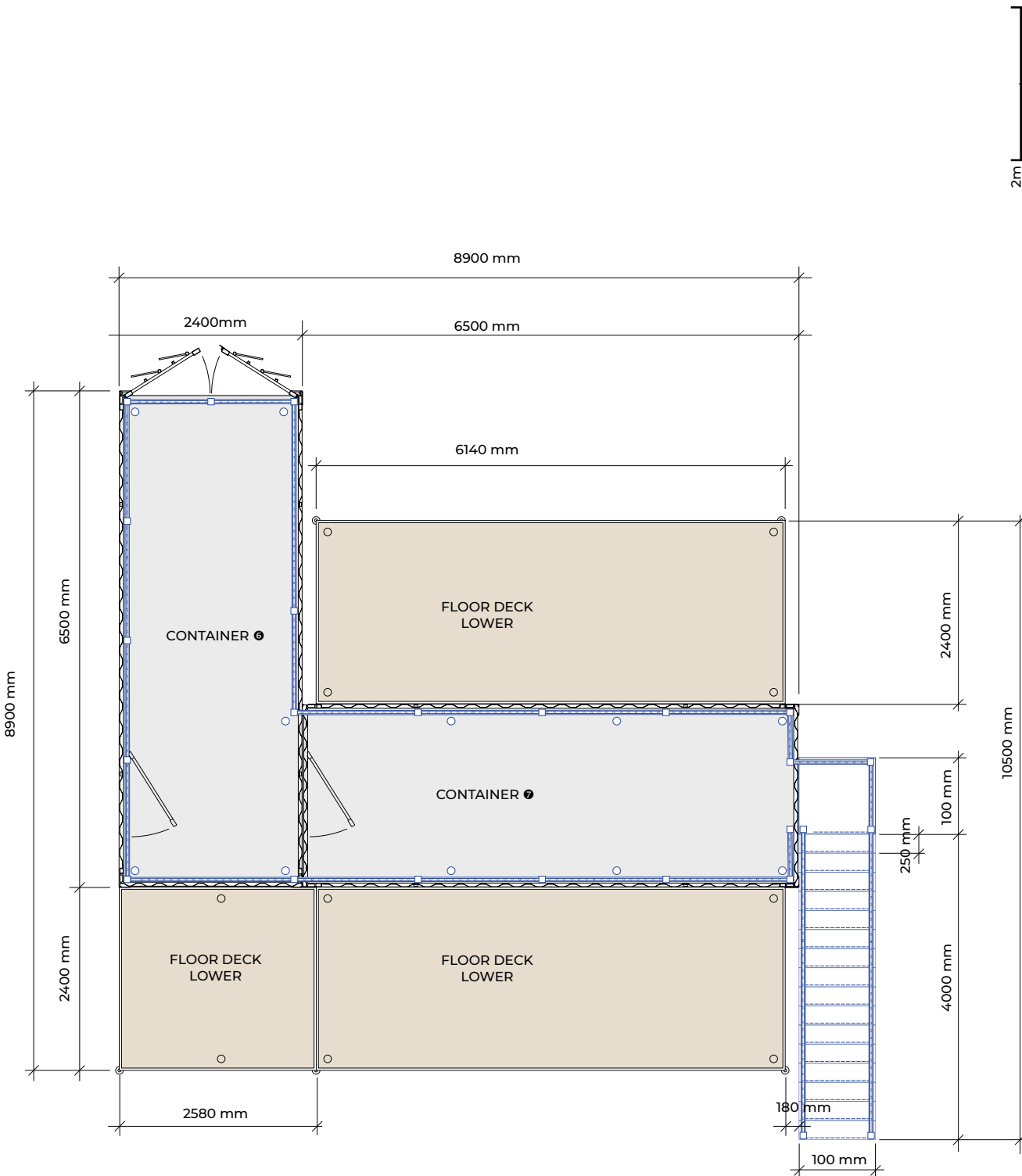

THE CRAFT BEER BUNKER – DIMENSIONS

aslactive.com

TECHNICAL DRAWING SERIES 2019

REVISIONS	
NO.	REMARKS
1	
2	
3	
4	
5	

NOT FOR CONSTRUCTION



+44 (0)8454 750 796 sarah@arenasportslive.com aslactive.com
ASL ACTIVATION & EVENTS, OXFORD, OX12 9FF UK



Contact Details

ASL ACTIVATION & EVENTS,
OXFORD, OX12 9FF UK